

SOUTH EX-II

A LEAP TOWARDS THE
EXTRA ORDINARY.



SEC-117, INTL. AIRPORT ROAD, MOHALI



South Ex-2, inspired from the most commercially acclaimed market of South Delhi, is a commercial bodega with scot plots and independent floors in the offerings. Impeccably located on the Intl. Airport Road in the prime vicinity of TDI Smart City Mohali, South Ex-II has everything extra-ordinary to offer for the leaders of tomorrow.

EX-II

SCO FLOORS AND PLOTS

WITH CONTEMPORARY
ARCHITECTURAL
EXCELLENCE.



SITE PLAN



LEGEND

SCO 401 to 411	92 Sq. Yds.
SCO 412	111 Sq. Yds
SCO 414 to 420	92 Sq. Yds.
SCO 421 to 482	121 Sq. Yds.
Hotel	307 Sq. Yds.
Anchor/ Hotel/ Commercial	560 Sq. Yds.

LAVISH HOTEL

AREA = 307 SQ. YDS.

Turning vision into reality, South Ex-II redefines the style of living with an indelible combination of luxury & comfort.

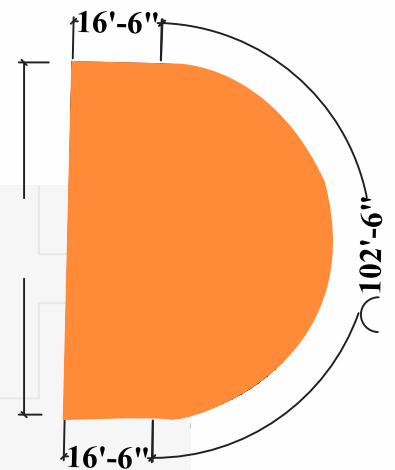

ANCHOR STORE/ HOTEL

AREA = 560 SQ. YDS.

Created with an individual perspective in mind, discover the joy and comfort of dining, shopping & sojourning at one place.

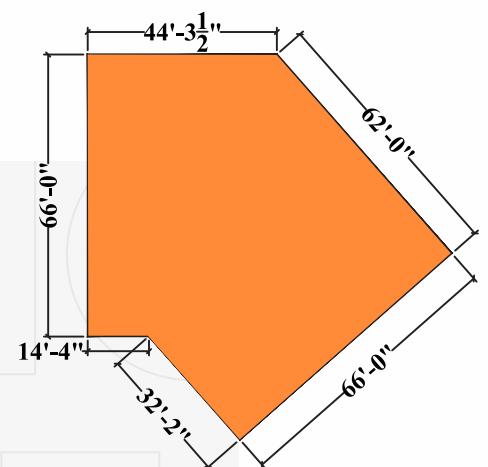

FLOOR PLANS

PLOT SIZE - 92 SQ. YDS. (Plot nos. 401 to 410 & 414 to 419)



PLOT SIZE - 111 SQ. YDS. (412) & 92 SQ. YDS (411)



PLOT SIZE - 111 SQ. YDS. (412) & 92 SQ. YDS (411)

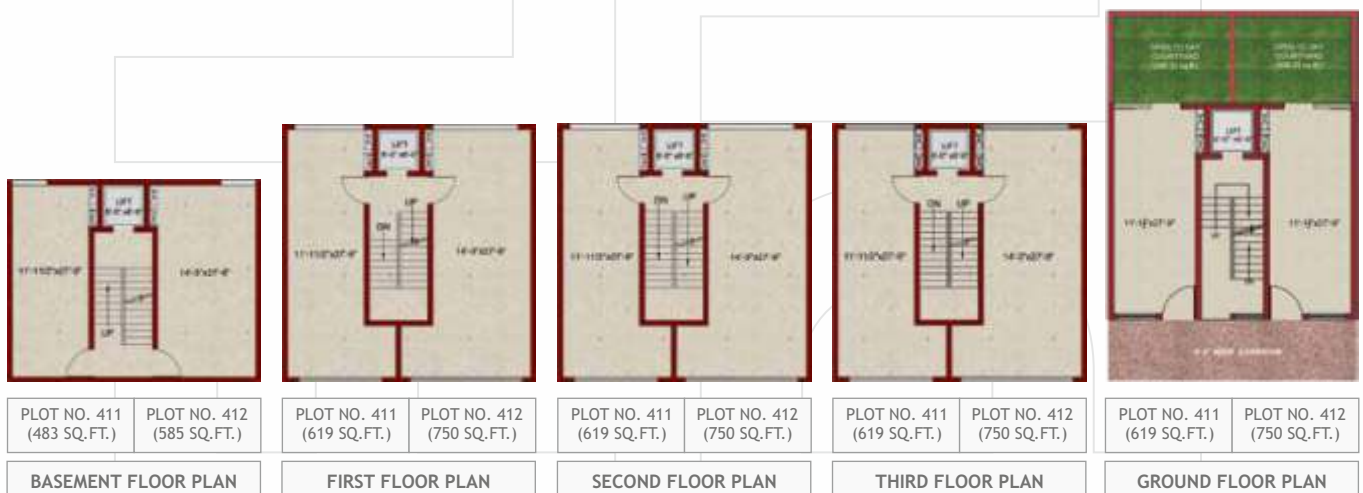

CONNECTIVITY FOR YOUR FUTURE GROWTH



Intl. Airport
20 Mins.



ISB
12 Mins.



PCA Stadium
12 Mins.



High Court
25 Mins.



ISBT Mohali
10 Mins.



Railway Station
15 Mins.



ISBT Chandigarh
18 Mins.



TDI INFRATECH LTD.

Head Office: 10, Shaheed Bhagat Singh Marg, Gole Market, New Delhi - 110001

Regional Office : SCO 678-679, Mohali-1, Sector-119, TDI City, Mohali | 91 9667 146 147

Contact : 011-49133333 Website: www.tdiinfratech.com | www.tdigroupmohali.net

1 sq.mtr. = 10.764 sq.ft.

Disclaimer: In the interest of maintaining a high standard, all floor plans, layout plans, areas, dimensions and specifications are indicative and subject to change as decided by the company or by any other competent authority. Soft furnishing, cupboards, furniture and gadgets are not part of the offering. All images are an artistic conceptualization and do not purport to replicate the exact products

CONNECT WITH US ON :



AN ISO 9001:2008 COMPANY



LOAN AVAILABLE

